



With Flange horizontal port inlets on the front side and Flange outlets on the back side. Two test connections positioned on the left and right hand side of the body. The isolating bonnets are positioned on the left and right hand side and the equalizing bonnet is positioned on the top.



GOST



CE

Standard Connection

| Product | Process side | Instrument side | Vent/Test |
|---------|--------------|-----------------|-----------------|
| 3VH | Flange | Flange | 1/4" NPT Female |

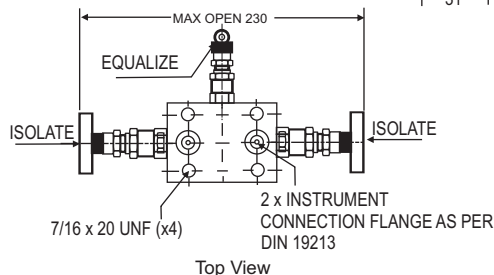
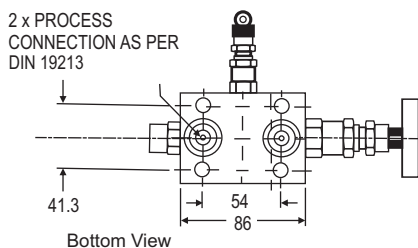
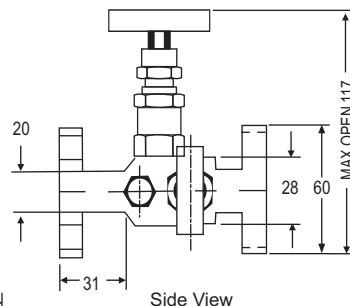
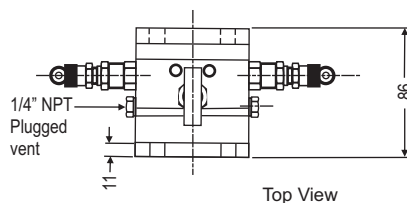
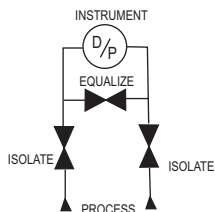

Notes : • Drawings are not to scale.
• All Dimensions are in mm.

Specifications - Standard Version 3VH

| | |
|-----------------------------|---|
| Body | : SS 316 |
| Stem | : SS 316 |
| Valve assembly | : SS 316 |
| 'T' bar handle | : SS 304 |
| Maximum working pressure | : 6000 psi |
| Maximum working temperature | : 240°C |
| Packing | : PTFE |
| Type of stem | : Type CT; Stem with conical metal tip |
| Drain port | : 1/4" NPT [F]; provided with SS 316 plug |
| Bracket mounting holes | : 4 Nos. with 12mm ID |

How To Order

| Body Material | Stem Type | Stem Packing | Size = Inlet x Outlet | Connections | Threads |
|------------------|-----------|----------------|-----------------------|-----------------------------|-------------------------------|
| C = Carbon Steel | CT (std) | P = PTFE (std) | 4F= 1/2" x Flange | FD = Female x Flange (54mm) | N = NPT (ANSI B 1.20.1) |
| S = SS 316 (std) | DS | G = Grafoil | 2F = 1/4" x Flange | SW = Socket Weld | P = BSPP (BS 2779, ISO 228/1) |
| S4 = SS 304 | | | | DD = Flange x Flange (54mm) | B = BSPT (BS 21, ISO 7/1) |
| SL = SS 316L | | | | | |
| M4 = Monel 400 | | | | | |
| M5 = Monel 500 | | | | | |
| H = Hastelloy C | | | | | |

Options

| | | |
|-------------|---|---|
| TF | : | Compliance to NACE standard |
| SG | : | For Oxygen service, valves are supplied cleaned, degreased and suitably packed. |
| GH | : | Material test certificate* |
| GO | : | Hydro test certificate |
| PRF | : | PTFE Ring For Flange Seal |
| GRF | : | Grafoil Ring For Flange Seal |
| BLD4 | : | Bleeder 1/4" NPT (Male) |
| D4 | : | 1/4" NPT Drain Plug |

* Material test certificate will be provided for wetted parts only with chemical composition testing. for others, please consult factory.

Example

To place an order simply refer to the codes in the table.

Valve Type : Body Material + Stem Type + Stem Packing + Size + Connections + Threads + Options

3VH + S + CT + P + 4F + FD + N = 3VH . S . CT . P . 4F . FD . N . Options

NOTE:

- The weld prepared types are available with female plain end - suitable for socket weld.
- Anti-tamper bonnet - special design on request with locking arrangement if desired.