

CENTERLINE

Butterfly Valves Series VIA/RS



CRANE[®]

CENTERLINE Butterfly Valves

Series VIA/RS

The preferred Industrial Valves for Critical Applications and Processes

Areas of application:

CENTERLINE Butterfly Valves Series VIA/RS are reliable, maintenance-free shutoff and control valves with permanently gas-tight seal. This valve has proved itself as a leakage-free and corrosion-resistant valve in various applications under most difficult operating conditions.

The safety and reliability of a valve is especially important when used for aggressive media – all components within the CENTERLINE Butterfly Valves Series VIA/RS have been designed accordingly.

Product features:

- Concentric design
- Soft seat design
- No pins needed to attach the disc to the shaft, only 2 parts in contact with the medium
- Replaceable body lining with firm back-up ring
- Permanently tight closure
- Optimum operation under vacuum conditions
- Standardized head flange for actuator adaption
- Materials for almost all media
- Short face-to-face dimension
- Maintenance-free version
- Blow-out proof shaft
- Direct mounting of actuators without any additional brackets

Over 70,000 Butterfly Valves Series VIA/RS are installed in 60 power generation sites and many sugar refineries worldwide. Used on the most arduous conditions, this is proof of the Series VIA/RS durability and reliability when in operation.

Main areas of application:

- Paper industry
- Sugar industry
- Power generation plants
- Chemical and petrochemical industry
- Steel industry
- Automotive industry
- Energy supply
- Shipbuilding industry
- Breweries
- Cement plants

Applications:

- Hot and cooling water
- Air-conditioning systems
- Drinking water systems
- Flue-gas desulphurisation
- Compressed air systems
- Vacuum systems
- Purification plants
- Sewage treatment plants
- Gas systems





Technical data:

- DN 40 – 1200
- PN 6, 10, 16, ANSI 150
- Temperature range from -34°C (-29°F) to +150°C (+302°F)
- Tightness in accordance with DIN 3230-T3, leakage rate 1
- Face-to-face dimension in accordance with EN 558-1, series 20
- Mounting flange in accordance with ISO 5211
- Shaft end DN 50 – 300 with square in accordance with DIN 3337
- Insulation in accordance with heating system regulation possible
- DVGW – gas approval
- Quality assurance in accordance with ISO 9001

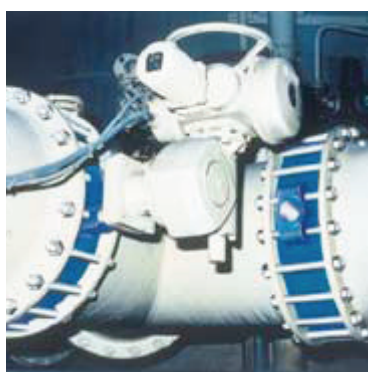

Design features

Corrosion resistance

With CENTERLINE Butterfly Valves Series VIA/RS only 2 parts of the valve come into contact with the medium. This means that neither the body nor mechanical parts such as the shaft are subject to the danger of corrosion.

The only two parts in contact with the medium are the body lining and the disc. These are available in a selection of materials so that a suitable corrosion resistant combination can be chosen for almost any application.

Permanently tight closure

CENTERLINE Butterfly Valves seal absolutely liquid and gas-tight in both flow directions due to their centric design.

The disc presses with a defined, uniform compression into the elastic body lining over the entire circumference of 360°. The power transmission between shaft and disc is accomplished by a square and enables axial movement and automatic centering of the disc. Excess stress and wear of the elastomer are avoided.

Elastic body lining

The replaceable body lining consists of a reinforced back-up ring, on which the elastic seat material is vulcanized. When mounting the valve between the pipe flanges this stable seat cannot be displaced or pushed out. When the valve closes a stretching and bulging of the elastomer in front of the closing disc is avoided.

The fixed connection between elastomer and back-up ring enables the application of the valve even under vacuum or high flow velocities. The slightly protruding sealing lip of the body lining constitutes at the same time the flange seal.

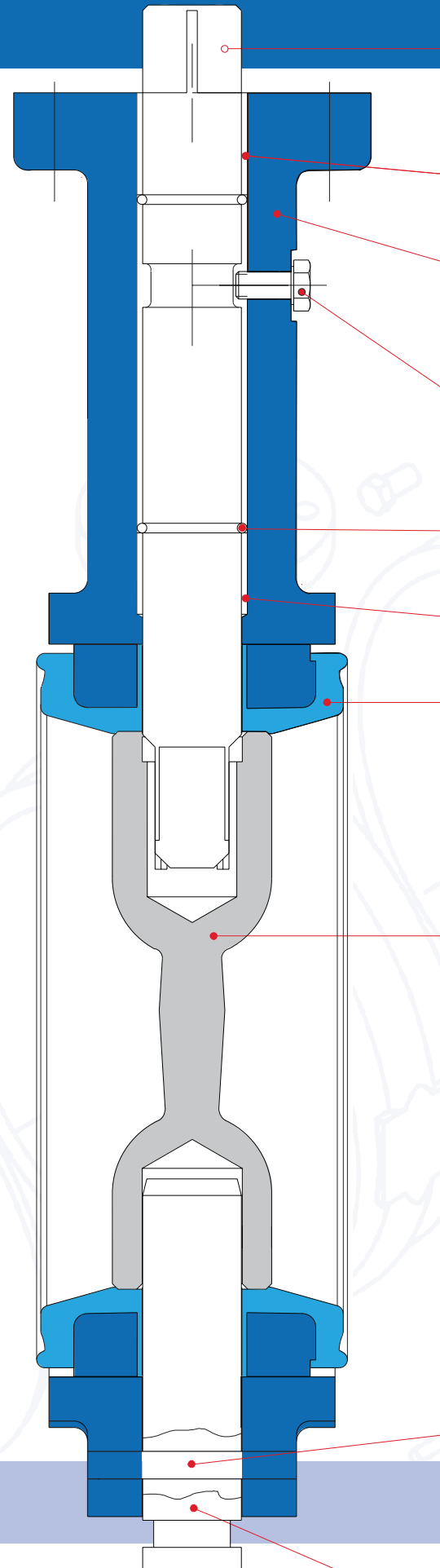

1

2

3

4

5

2

6

7

1 Shaft

2 Bearing bush

3 Body

4 Shaft lock

5 Citclip

6 Body lining
(with vulcanized back-up ring)

7 Disc

8 Dowelling

9 Lower Stem

8

9



Maintenance-free operation

The shafts of the CENTERLINE Butterfly Valves Series VIA/RS are mounted in self-lubricating DU bearing bushes so that there is no need for maintenance even after a long operating period.

Shaft lock

All CENTERLINE Butterfly Valves Series VIA/RS feature a lock at the valve neck avoiding a blowing-out of the shaft during the valves operations life.

Actuator mounting

All CENTERLINE Butterfly Valves Series VIA/RS feature a mounting in accordance with ISO 5211 for the mounting of hand lever, gear, pneumatic REVO or other automatic actuators.

A conversion – even during operation – from manual to automatic actuator and reverse is possible without any difficulties.

Actuator adaptation

CENTERLINE Butterfly Valves Series VIA/RS are available for 3 closing pressures (operating pressures) – 3.5 bar (51 psi), 10 bar (145 psi) and 16 bar (232 psi). The actuator size can be selected individually against the pipeline pressure available, so that with lower pipeline pressures even smaller actuators can be utilised due to the lower torque's.



Versions available

With the proven modular system, CENTERLINE Butterfly Valves Series VIA/RS can be directly equipped with a variety of actuators. Available ex stock, various manual actuators together with those from the REVO pneumatic range can be fitted and assembled quickly to meet your needs. A number of accessories including three way version and shaft extensions are also available. Contact your local stockist for more information.



**Wafer body
with centering lugs**

DN 50 - 300
PN 6, 10, 16
ANSI 150

Wafer body

DN 50 - 600
PN 6, 10, 16
ANSI 150

Lug-type body

DN 50 - 600
PN 6, 10, 16
ANSI 150

Standards considered



Lug-type body
Flange body

DN 700 - 1200
PN 10, 16
MSS-SP44

Design:	EN 593
Face-to-face dimension:	EN 558-1, Series 20 (previously DIN 3202-K1) ISO 5752-short
Head flange:	ISO 5211
Shaft end:	DIN 3337-square (only for DN 40-300)
Flange connection:	EN 1092-1, EN 1759-1, ANSI B16.5, Class 150 MSS-SP 44
Testing:	DIN 3230-T3, leakage rate 1
Identification:	EN 19 MSS SP-25 CE in accordance with PED 97/23 EG
Quality assurance:	ISO 9001
Approvals:	DVGW Lloyds Register Det Norske Veritas American Bureau of Shipping Leybold Systems Vakuumtest





Crane Process Flow Technologies GmbH

P.O.-Box 11 12 40
D-40512 Düsseldorf
Heerdter Lohweg 63-71
D-40549 Düsseldorf
Phone +49 211 5956-0
Fax +49 211 5956-111



CENTERLINE-Butterfly Valves Series VIA/RS

Model Numbers DN 40-1200

RS/DB-0002-GB/09.01/GP

A	M	G	D	1	E	1	0	0	H
1	2	3	4	5	6	7	8	9	10

1. Series:
A = Series VIA/RS

2. Size:	
G = 040 (1,5")	U = 350 (14")
H = 050 (2")	V = 400 (16")
K = 065 (2,5")	W = 450 (18")
L = 080 (3")	X = 500 (20")
M = 100 (4")	Y = 600 (24")
N = 125 (5")	Z = 700 (28")
P = 150 (6")	2 = 800 (32")
R = 200 (8")	3 = 900 (36")
S = 250 (10")	4 = 1000 (40")
T = 300 (12")	7 = 1200 (48")

3. Disc Material and Shutoff Pressure:	
B = Stainless steel ⁶⁾	3,5 bar
G = Stainless steel	10 bar
S = Stainless steel	16 bar
C = Ductile iron, nickel-plated ²⁾ ⁶⁾	3,5 bar
H = Ductile iron, nickel-plated ²⁾	10 bar
T = Ductile iron, nickel-plated ²⁾	16 bar
A = Aluminium bronze ⁶⁾	3,5 bar
F = Aluminium bronze	10 bar
R = Aluminium bronze	16 bar
K = ECTFE, coated	10 bar
L = Rilsan, coated ²⁾	10 bar
P = Hostalen-GUR ³⁾	10 bar
N = Duplex	10 bar
M = Hastelloy	10 bar

4. Pressure Class:					
Body Design	DN PN	40-	200-	500-	700-
		150	450	600	1200
Wafer body	PN 6*	A	A	-	-
	PN 10	-	-	B	-
	PN 16	-	-	C	-
	PN 10/16	D	D	-	-
	ANSI 150**	N	N	N	-
MSS-SP 44	-	-	-	-	
Lug-type body/ Flanged body	PN10	-	B	B	B
	PN16	-	C	C	C
	PN 10/16	D	-	-	-
	ANSI 150**	N	N	N	-
MSS-SP 44	-	-	-	S	

* DN50-300 only GG

** not DN40

¹⁾ further versions available on request

²⁾ not DN40-150

³⁾ only DN50-800

⁴⁾ Registered trademark or trade name

⁵⁾ with centering lugs, not DN40

⁶⁾ not DN50-80

5. Body Design / Material:
1 = Wafer body GGG40 (only DN40-600)
2 = Wafer body GG25 ^{*5)} (only DN40-300)
5 = Lug body GGG40
7 = Lug body GS-C25 (only DN40-600)
8 = Flanged body GGG40 (only DN700-1200)

6. Body Liner Material:
B = NBR (Buna-N ⁴⁾)
C = HNBR (only DN40-600)
E = EPDM
F = EPDM-H with KTW-approval
H = CSM (Hypalon ⁴⁾)
V = FPM (Viton ⁴⁾)

7. Shaft Material:
1 = Cr steel (standard)
2 = CrNi steel

8. + 9. Design ¹⁾:
00 = Standard
UD = Pressure and leak test BA/BN acc. to DIN 3230-T3 as well as material certification for body approved acc. to EN 10204- 3.1B
UG = Pressure and leak test BA/BN acc. to DIN 3230-T3 as well as material certification for body approved acc. to EN 10204- 3.1B as well as separate KKS head flange tag

10. Actuation ¹⁾:
F = bare shaft
G = Gear operator with hand wheel
H = 10 pos. hand lever (only up to DN200)

Each CENTERLINE Butterfly Valve Series VIA/RS has a name plate with the model number stamped on. This number is complete to such an extent that it specifies each detail of the valve. It can be taken from the model numbering system above.

Ordering example:

CENTERLINE Butterfly Valve Series VIA/RS, DN 100, PN10/16, shutoff pressure of 10 bar, wafer body GGG40, shaft made of Cr steel, stainless steel disc, body liner EPDM, with 10 pos. hand lever

Modell Number: AMGD1E100H

CRANE®

Model Numbers for Gear Operators

The model number of the gear operator is composed of a basic number and a specification number. The basic number is to be taken from the table below. The specification number is based on the following code:

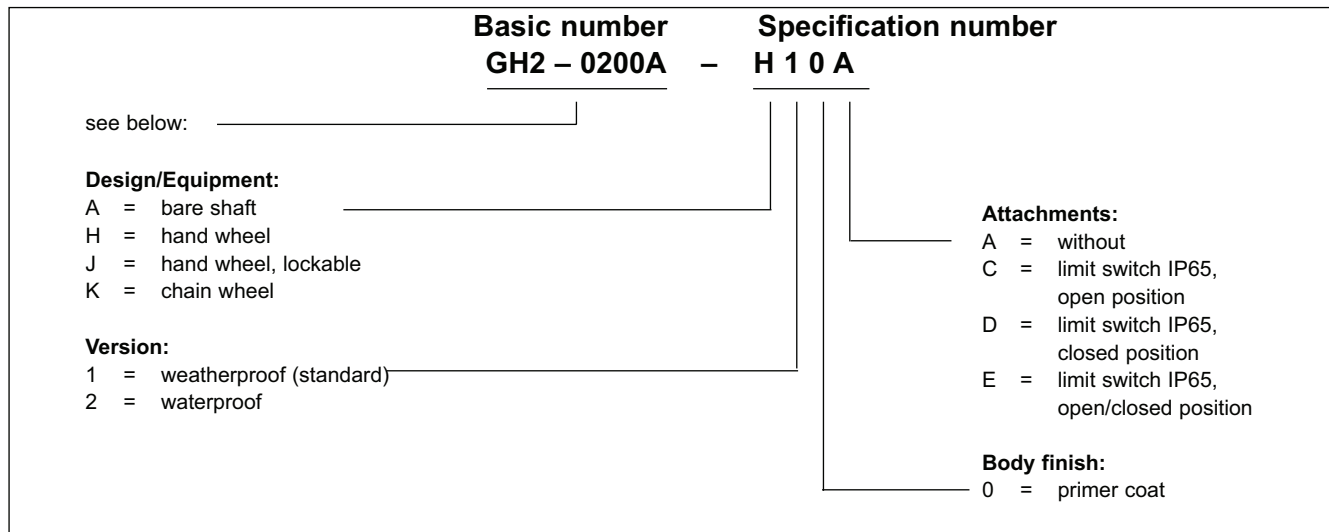

Basic numbers for gear operators

CENTERLINE Valve Series VIA/RS		Gear Operator Basic number	CENTERLINE Valve Series VIA/RS		Gear Operator Basic number
DN	Shutoff pressure		DN	Shutoff pressure	
40-100	3,5 bar, 10 bar, 16 bar	GH2-0100A-	700	3,5 bar, 10 bar	GH2-0700B-
125-200	3,5 bar, 10 bar, 16 bar	GH2-0200A-	800	16 bar	GH2-0800A-
250-300	16 bar	GH2-0300A-		10 bar	GH2-0800B-
	3,5 bar, 10 bar,	GH2-0300B-		3,5 bar	GH2-0800C-
350-400	3,5 bar, 10 bar, 16 bar	GH2-0500B-	900	16 bar	GH2-0900A-
450-500	16 bar	GH2-0500A-		10 bar	GH2-0900B-
	3,5 bar, 10 bar	GH2-0500B-		3,5 bar	GH2-0900C-
600	16 bar	GH2-0600A-	1000	3,5 bar, 10 bar	GH2-1000A-
	3,5 bar, 10 bar	GH2-0600B-	1200	3,5 bar, 10 bar	GH2-1200B-
700	16 bar	GH2-0700A-			

Selection table hand lever/gear operator

The following table is a recommendation





Shutoff pressure	DN				
	40-125	150	200	250	300-1200
16 bar	Hand lever		Gear Operator		
10 bar					
3,5 bar					

Hand lever up to DN200, gear operator available from DN40 on

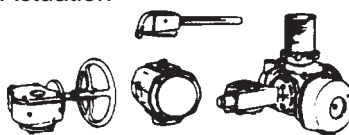

CENTERLINE-Butterfly Valves Series RS

Possible Combinations

Component	Version	DN	Material
	Hand lever, 10 positions	40-200	-
	Hand lever, infinitely adjustable	40-200	-
	Gear operator	40-1200	-
	Pneumatic Revo actuator	40-1200	-
	Hydraulic actuator	40-1200	-
	Electric actuator	40-1200	-
	-	40-1200	Chromium steel
	-	40-1200	Stainless steel
	-	40-1200	NBR
	-	40-1200	HNBR
	-	40-1200	EPDM
	-	40-1200	FPM
	-	40-600	CSM
	-	40-1200	EPDM-H
	-	200-600	Ductile iron, nickel-plated
	-	40-1200	Stainless steel
	-	40-700	Aluminium bronze
	-	200-1200	GGG-Rilsan coated ¹⁾
	-	40-1200	GGG-ECTFE coated ¹⁾
	-	40-600	Hastelloy-C ^{1) 2)}
	-	700-1200	Hastelloy-C22C ^{1) 2)}
	-	40-1200	Super Duplex ¹⁾
	-	50-1200	Hostalen GUR lined ¹⁾
	-	40-1200	Chromium steel
	-	40-700	Stainless steel

RS/DB-0003-GB/07.04/GP

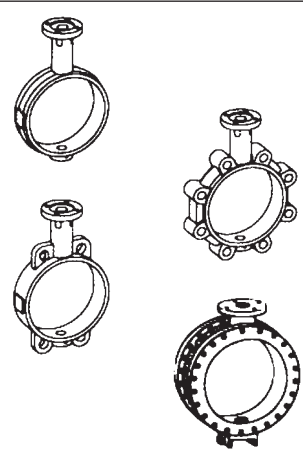
Body	Version	Material	DN 40-300	DN 350-600	DN 700-900	DN 1000-1200
	Wafer body	GGG-40	PN 10/16/ANSI 150	PN 10/16/ANSI 150	-	-
	Lug body ⁴⁾	GGG-40	PN 10/16/ANSI 150	PN 10/16/ANSI 150	PN 16/MSS-SP44	MSS-SP44
		GS-C25	PN 10/16/ANSI 150	PN 10/16/ANSI 150	-	-
	Wafer body with centering lugs	GG 25 ³⁾	PN 6/10/16	-	-	-
Flanged body	GGG 40	-	-	PN 10	PN 10/16	

¹⁾ only for shutoff pressure of 10 bar

²⁾ or equivalent

³⁾ DN 40 only wafer body, not PN 6

⁴⁾ Through hole thread

CRANE[®]

CENTERLINE-Butterfly Valves Series VIA/RS

Material Selection DN 40-600

RS/DB-0004-GB/10.01/GP

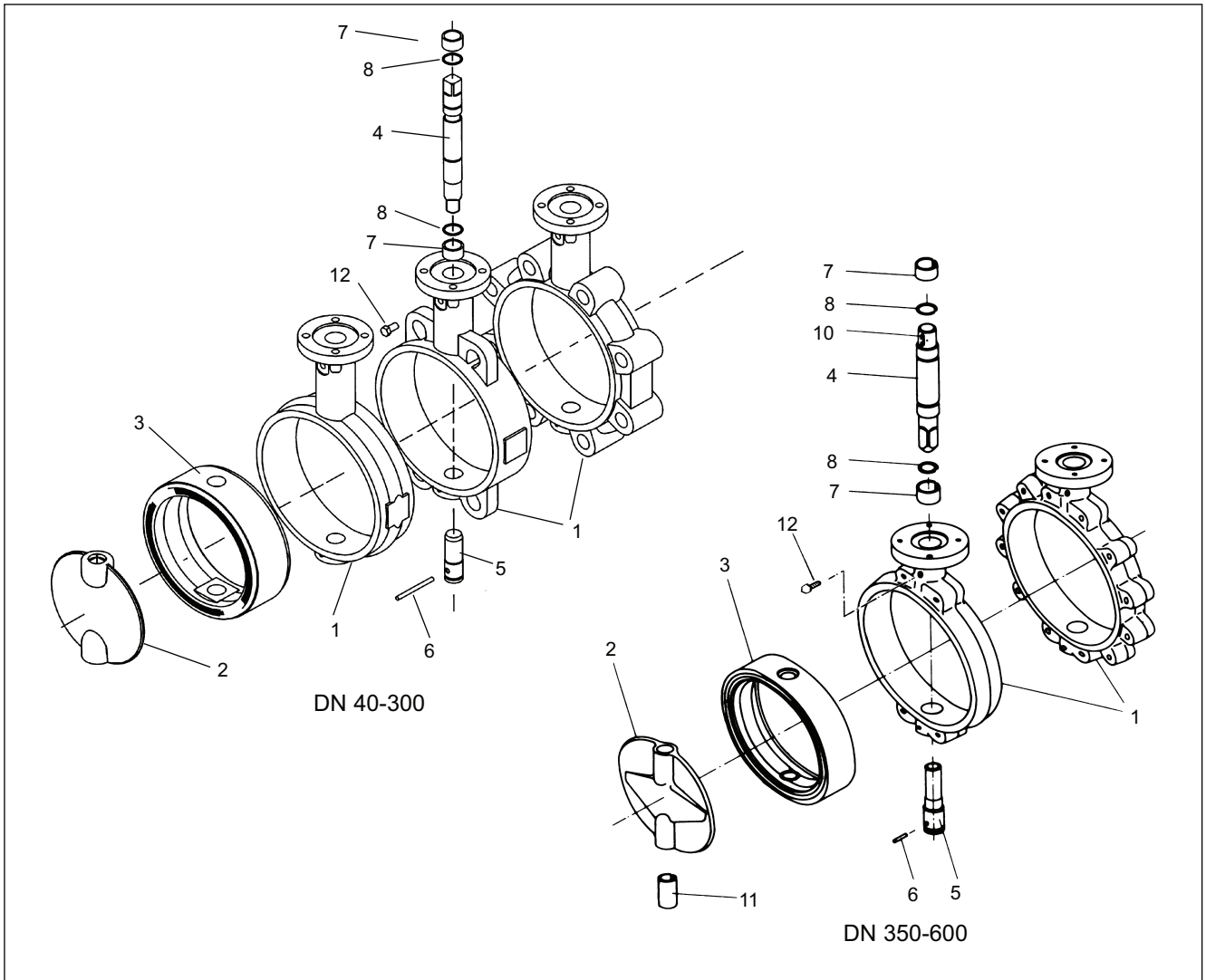

	Component	Material specification	Material no.
Parts not in contact with the medium	Body (1)	EN-GJL-250 ¹⁾ EN-GJS-400-15 GP 240 GH	JL-1040 JS-1030 1.0619
	Shaft (4) and Pin (5)	Chromium steel X20Cr13 Stainless steel X5CrNiMo 18/10	1.4021 1.4401
	Roll pin (6)	Spring steel, galvanized	
	Bushing (7)	DU/ plastics ²⁾	
	Retaining ring (8)	Spring steel, galvanized	
	Key (10)	Steel	
	Bushing (11)	Bronze	
	Screw (12)	Galvanized steel	

¹⁾ only wafer body with centering lugs (DN50-300) ²⁾ according to the manufacturer's choice

	Component	Material specification	Material no.	Temperature range
Parts in contact with the medium	Disc (2)	Ductile iron, nickel-plated GGG-40-gal Ni ¹⁾	JS-1030	-10 °C, top temperature limited by body liner
		Ductile iron, VIADUR-coated ¹⁾	JS-1030	-10 °C bis +80 °C
		Ductile iron, ECTFE-coated	JS-1030	-10 °C, top temperature limited by body liner
		Ductile iron, Hostalen Gur lined	UHMWPE	-10 °C bis +70 °C
		Aluminium bronze G-CuAl 10Ni	2.0975.01	limited by body liner
		Stainless steel, according to manufacturer's choice G-X5CrNiMo 19-11-2 G-X5CrNiMoNb 18/10	1.4408 1.4581	limited by body liner
		Duplex steel G-X2CrNiMoCuN 27 77 43	9.4517	limited by body liner
		Hastelloy C* G-NiMo16Cr	2.4883	limited by body liner
	Body liner (3)	EPDM (ethylene-propylene-terpolymer)		-34 °C to +120 °C
		EPDM-H (ethylene-propylene-terpolymer)		-34 °C to +140 °C (with KTW-approval)
		NBR (perbunane) (copolymer of acrylonitrile-butadiene rubber)		-20 °C to +80 °C (up to 100°C with intermittend operation)
		HNBR (hydrogenated acrylonitrile-butadiene rubber)		-20 °C to +120 °C
		FPM (Viton)* (copolymer of vinyl fluoride)		-5 °C to +150 °C
		CSM (Hypalon) (chlorine-sulfonated polyethylene)		-20 °C to +80 °C (up to 100°C with intermittend operation)

* or equivalent

¹⁾only DN 200-600

CENTERLINE-Butterfly Valves Series VIA/RS

Dimensions/ Weights DN 40-600

RS/DB-0006-GB/10.01/GP

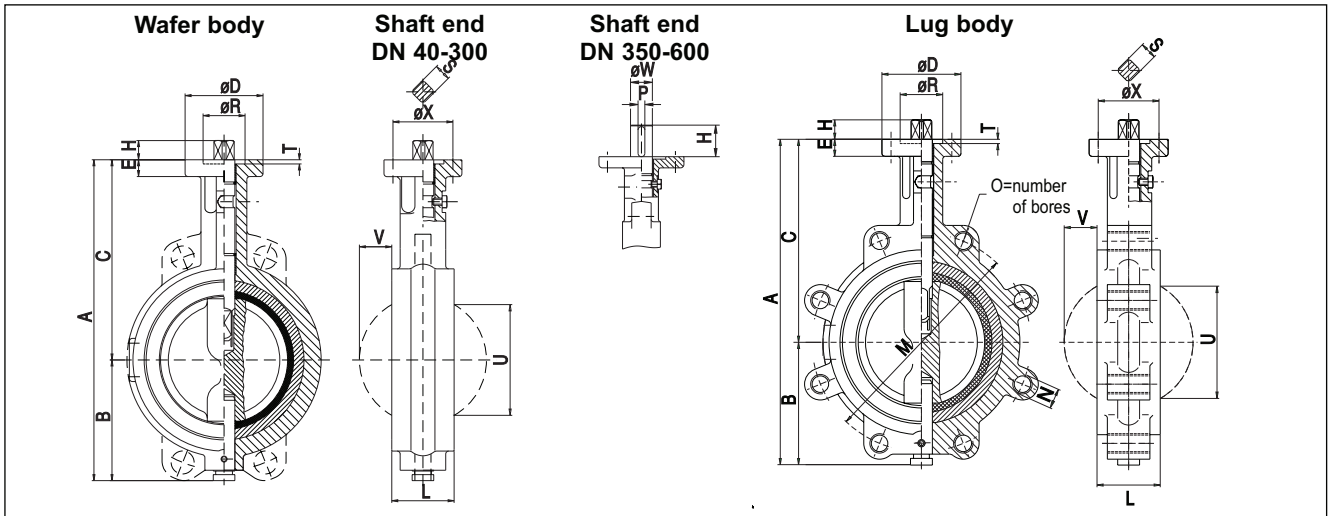

Dimensions in mm, bare shaft

Mea- sure- ment	Pressure class	Size																		
		40 ³⁾ 1 1/2"	50 2"	65 2 1/2"	80 3"	100 4"	125 5"	150 6"	200 8"	250 10"	300 12"	350 14"	400 16"	450 18"	500 20"	600 24"				
A ¹⁾		202	202	225	240	268	292	320	386	462	542	627	677	743	793	934				
A ²⁾		202	202	225	251	286	314	342	401	462	542	-	-	-	-	-				
B		72	72	79	86	101	112	125	156	192	242	277	302	341	366	424				
C ¹⁾		130	130	146	154	167	180	195	230	270	300	350	375	402	427	510				
C ²⁾		130	130	146	165	185	202	217	245	270	300	-	-	-	-	-				
D ⁴⁾		65			90				125				175				210			
E ⁴⁾		14			15				18				23				25			
H ⁴⁾		16			19				24				65				80			
L ⁴⁾		43	43	46		52	56		60	68	78	78	102	114	127	154				
M	PN 10	110	125	145	160	180	210	240	295	350	400	460	515	565	620	725				
M	PN 16	110	125	145	160	180	210	240	295	355	410	470	525	585	650	770				
M	ANSI 150	-	120,7	139,7	152,4	190,5	215,9	241,3	298,5	362	431,3	476,3	539,8	577,9	635	749,3				
N	PN 10	M 16				M 20				M 20				M 24				M 27		
N	PN 16	M 16				M 20				M 24				M 27				M 30	M 33	
N	ANSI 150	-	5/8"-11 UNC				3/4"-10 UNC				7/8"-9 UNC				1"-8 UNC				1 1/8"-7 UNC	1 1/4"-7 UNC
O	PN 10	4			8			8			12			16			20			
O	PN 16	4			8			12			12			16			20			
O	ANSI 150	-	4			8			12			16			20					
P		-								14				20						
R		Ø35				Ø55				Ø70				Ø100				Ø130		
S ⁴⁾		□14-0,1				□17-0,1				□22-0,1				-						
T		3,5								5								7		
U		39	39	56	71	93	117	144	191	240	291	327	371	423	472	575				
V		7	7	13	19	27	37	49	70	90	111	129	141	162	181	221				
W		-								Ø45								Ø70		
X		Ø50/4 x Ø7				Ø70/4 x Ø9				Ø102/4 x Ø11				Ø140/4 x Ø18				Ø165/4 x Ø22 F16		
		F05				F07				F10				F14						

¹⁾ Body made of GGG/GS-C ²⁾ Body made of GG ³⁾ Inner parts DN 50 ⁴⁾ Dimensions in accordance with DIN/ISO

Weights in kg

Bare shaft valve	Size															
	40	50	65	80	100	125	150	200	250	300	350	400	450	500	600	
Wafer body*	2,2	2,2	2,8	3,4	4,7	6,8	7,6	11,5	19,6	31,2	50	72	92	111	195	
Lug body	3,4	3,4	4,0	4,8	6,9	10,6	11,4	15,9	26,0	38,2	60	92	108	151	245	

* version with centering lugs made of GG25 up to DN300

CRANE

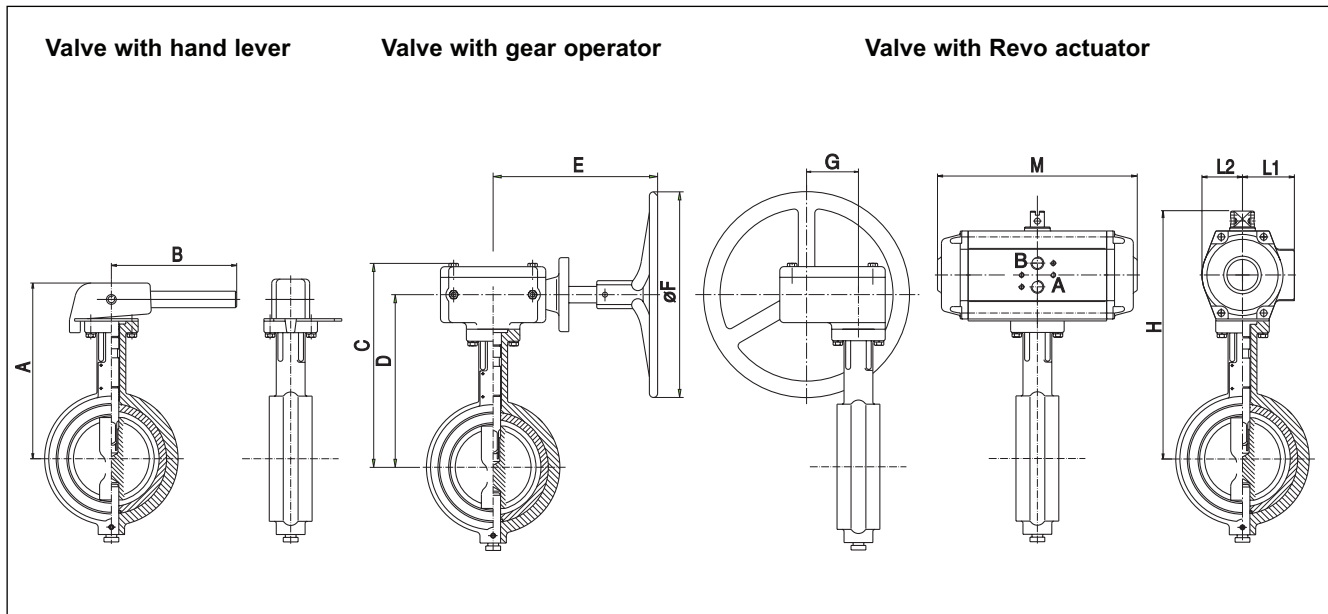

Dimensions in mm*, with actuations

Measurement	Size														
	40	50	65	80	100	125	150	200	250	300	350	400	450	500	600
A ¹⁾	181	181	197	205	218	231	246	281	-	-	-	-	-	-	-
A ²⁾	181	181	197	216	236	253	268	296	-	-	-	-	-	-	-
B	200	200	200	200	200	240	240	240	-	-	-	-	-	-	-
C ¹⁾	206	206	222	230	243	256	271	306	346	376	437	462	489	514	616
C ²⁾	206	206	222	241	261	278	293	321	346	376	-	-	-	-	-
D ¹⁾	172	172	188	196	209	222	237	272	312	342	402	427	454	479	560
D ²⁾	172	172	188	207	227	244	259	287	312	342	-	-	-	-	-
E	230	230	230	230	230	230	230	230	230	230	285	285	285	285	366
F	200	200	200	200	200	250	250	250	250	250	400	400	400	400	610
G	65	65	65	65	65	65	65	65	65	65	96	96	96	96	123
H ¹⁾	216	216	232	266,5	308	321	361	396	456	486	652	677	704	729	962
H ²⁾	216	216	232	277,5	326	343	383	411	456	486	-	-	-	-	-
L1	38	38	38	52,5	67	67	79	79	94	94	135	135	135	135	211
L2	33	33	33	41	55	55	67	67	78	78	119	119	119	119	211
M	175	175	175	205	214	214	267	267	355	355	388	388	510	510	533

* Dimensions apply to valves PN 10/16 Δ p 10 bar, Revo actuator, double-acting at 5 bar air supply

¹⁾ Body made of GGG/GS-C

²⁾ Body made of GG

Weights in kg**

Valve with	Size														
	40	50	65	80	100	125	150	200	250	300	350	400	450	500	600
Hand lever	3,8	3,8	4,4	4,6	5,9	8,5	9,5	13,6	24,5	35,9	-	-	-	-	-
Gear operator	10,2	10,2	10,8	11,0	12,3	14,8	15,8	19,9	27,6	39,0	66,8	88,8	108,8	127,8	230,0
Revo actuator	4,3	4,3	4,9	5,6	8,1	10,6	11,4	19,4	31,2	43,2	76,0	104,0	129,0	148,0	318,0

** Weights apply to valves with wafer body



CENTERLINE-Butterfly Valves Series VIA/RS

Dimensions/ Weights DN 700-1200

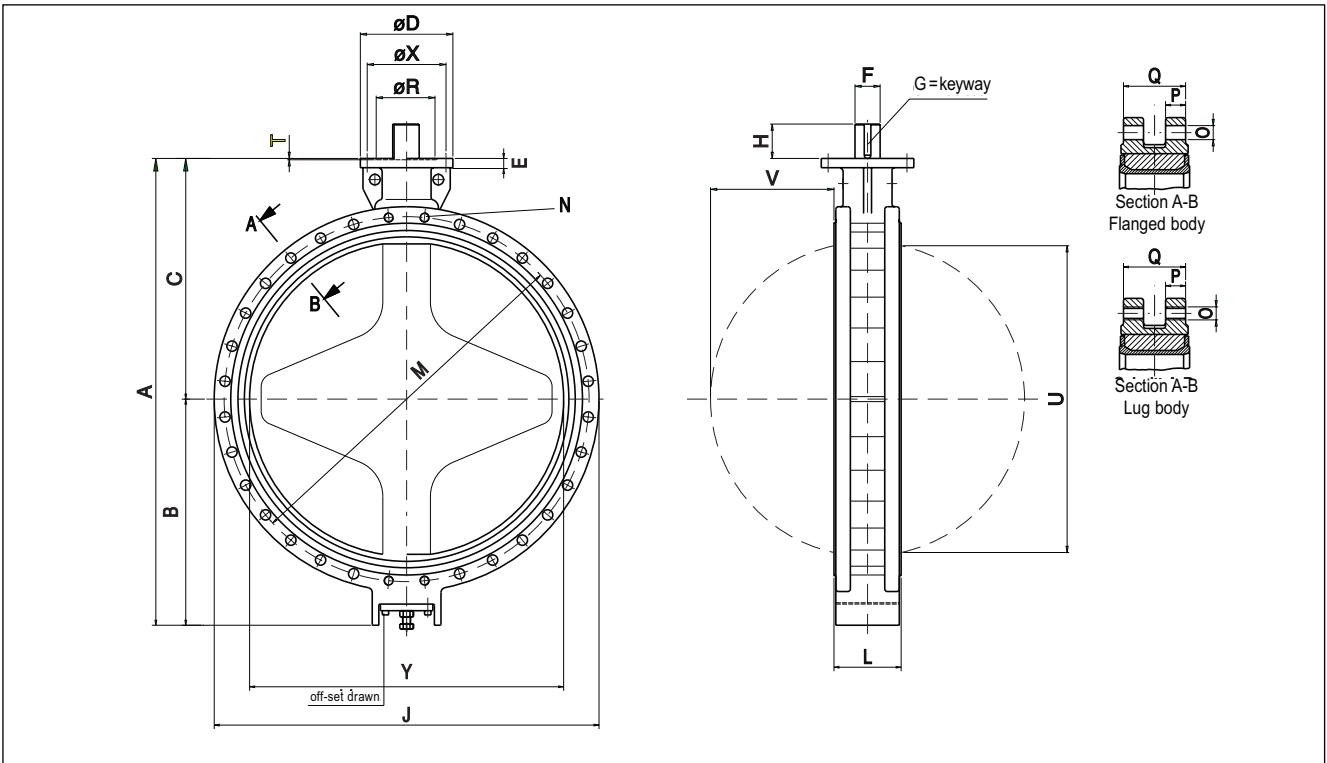

Dimensions in mm, bare shaft end

Measurement	Pressure-class	Size				
		700 28"	800 32"	900 36"	1000 40"	1200 48"
A		1065	1200	1330	1540	1765
B		515	580	640	750	855
C		550	620	690	790	910
D ³⁾		ø300			ø350	
E		25			35	
F		ø70	ø75	ø85	ø90	ø95
G		20 x 115	20 x 115	22 x 115	25 x 130	25 x 130
H		110			130	
J	PN10	910	1025	1125	1230	1455
	PN16	910	1025	1125	1255	1485
L ³⁾		165	190	203	216	254
M	PN10	ø840	ø950	ø1050	ø1160	ø1380
	PN16	ø840	ø950	ø1050	ø1170	ø1390
N	PN10	2x4xM27x35 deep	2x4xM30x43 deep	2x4xM30x43 deep	2x4xM33x48 deep	2x4xM36x48 deep
	PN16	2x4xM33x40 deep	2x4xM36x43 deep	2x4xM36x43 deep	2x4xM39x48 deep	2x4xM45x48 deep
O ¹⁾	PN16	2 x 20 x M33	2 x 20 x M36	2 x 24 x M36		
O ²⁾	PN10	2 x 20 x ø30	2 x 20 x ø33	2 x 24 x ø33	2 x 24 x ø36	2 x 28 x ø39
	PN16	2 x 20 x ø30	2 x 20 x ø33	2 x 24 x ø33	2 x 24 x ø42	2 x 28 x ø48
R ³⁾		ø200			ø230	
T		5				
U		669	766	865	965	1160
V		262	300	343	387	467
X		ø254/8 x ø 17,5 (F25)			ø298/8 x ø 22(F30)	
Y		686	786	885	986	1186
P		45	50	50	50	55
Q		155	180	190	206	244

¹⁾ Lug body

²⁾ Flanged body

³⁾ Dimensions in accordance with DIN/ISO

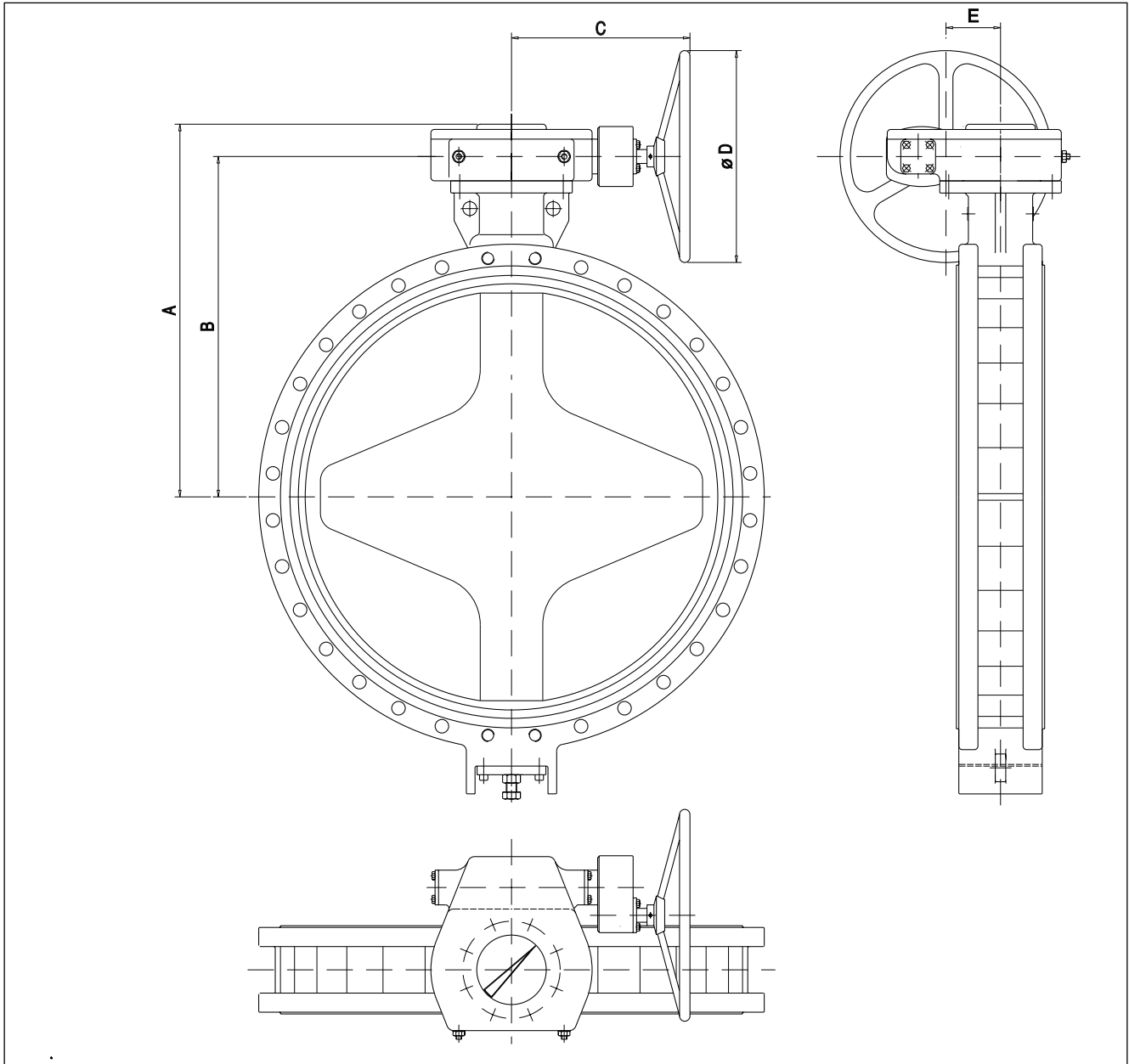

Dimensions in mm, (valve with gear operator *)

Measurement	700 28"	800 32"	Size 900 36"	1000 40"	1200 48"
A	678	748	849	954	1074
B	616	686	754	860	980
C	497	497	529	551	551
D	610	610	610	610	610
E	138	138	181	237	237

* for valves Δp 10 bar

Weights in kg

Measurement	700 28"	800 32"	Size 900 36"	1000 40"	1200 48"
flanged/lug body bare shaft	450	550	700	900	1350
flanged/ lug body with gear operator	515	615	808	1069	1519



CENTERLINE-Butterfly Valves Series VIA/RS

Gear Operators for Butterfly Valves DN 40-1200

Model Numbers and Weights

Valve		Gear operator with handwheel		Gear operator with lockable handwheel		Gear operator with chainwheel	
DN	Shutoff pressure bar	Model	Weight kg	Model	Weight kg	Model	Weight kg
40-100	3,5-16	GH2-0100A-H10A	7,8	GH2-0100A-J10A	8,0	GH2-0100A-K10A	7,7
125-200	3,5-16	GH2-0200A-H10A	8,0	GH2-0200A-J10A	8,2	GH2-0200A-K10A	7,7
250-300	3,5-10	GH2-0300B-H10A	10,8	GH2-0300B-J10A	10,4	GH2-0300B-K10A	7,7
250-300	16	GH2-0300A-H10A	19,6	GH2-0300A-J10A	19,8	GH2-0300A-K10A	16,6
350-400	3,5-16	GH2-0500B-H10A	16,8	GH2-0500B-J10A	17,4	GH2-0500B-K10A	21,2
450-500	3,5-10	GH2-0500B-H10A	16,8	GH2-0100B-J10A	17,4	GH2-0500B-K10A	21,2

Article number for chain: 6104010. When ordering specify length.

RS/DB-0008-GB/02.03/GP

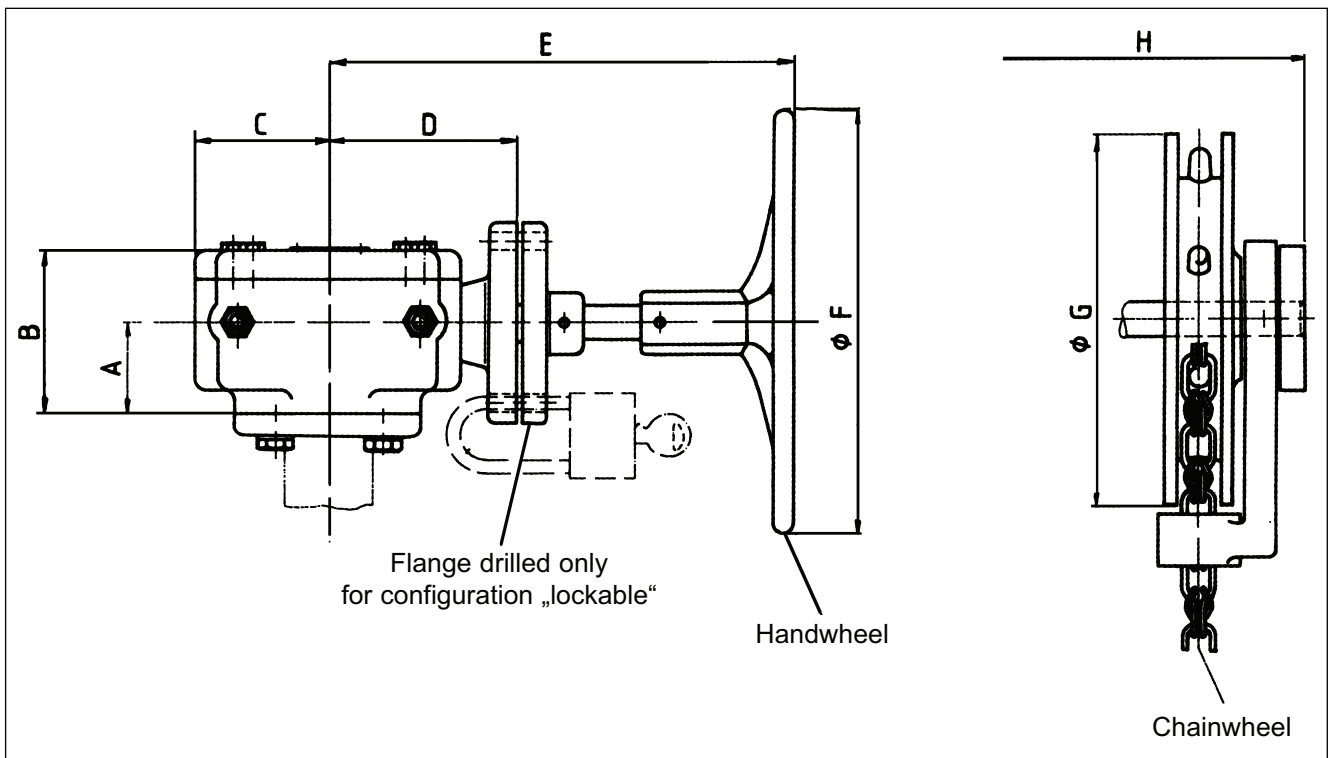

Dimensions

Gear operator model	Handwheel turns for 90°	Dimensions in mm										
		A	B	C	D	E	F	G	H	K	L	M
GH2-0100A	10	42	76	64	92	230	200	265	184	184	65	45
GH2-0200A	10	42	76	64	92	230	250	265	184	184	65	45
GH2-0300B	10	42	76	64	92	230	250	265	184	184	65	45
GH2-0300A	19	52	87	100	134	282	400	365	212	242	96	64
GH2-0500B	19	52	87	100	134	282	400	365	212	242	96	64

CRANE[®]

Model Numbers and Weights

Valve		Gear operator with handwheel		Valve		Gear operator with handwheel	
DN	Shutoff pressure bar	Model	Weight Kg	DN	Shutoff pressure bar	Model	Weight kg
450/500	16	GH2-0500A-H10A	32	800	16	GH2-0800A-H10A	169
600	3,5-10	GH2-0600B-H10A	32	900	3,5	GH2-0900C-H10A	65
	16	GH2-0600A-H10A	65		10	GH2-0900B-H10A	108
700	3,5-10	GH2-0700B-H10A	65	1000	16	GH2-0900A-H10A	169
	16	GH2-0700A-H10A	108		3,5-16	GH2-1000A-H10A	169
800	3,5	GH2-0800C-H10A	65	1200	3,5-10	GH2-1200B-H10A	169
	10	GH2-0800B-H10A	65		16	GH2-1200A-H10A	262

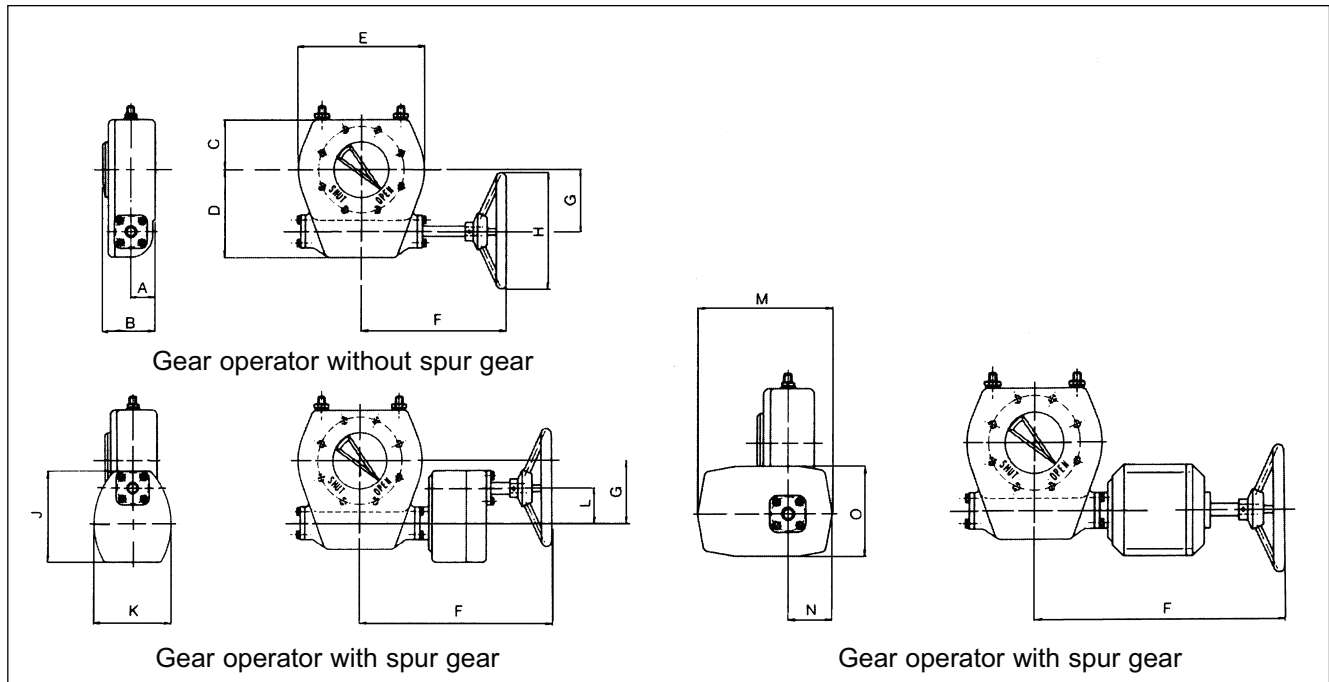

Dimensions

Gear operator Model	Handwheel turns for 90°	Dimensions in mm													
		A	B	C	D	E	F	G	H	J	K	L	M	N	O
GH2-0500A/0600B	17	50	106	114	178	252	366	123	610	-	-	-	-	-	-
GH2-0600A	43	66	128	155	195	310	497	138	610	210	171	78	-	-	-
GH2-0700B	43	66	128	155	195	310	497	138	610	210	171	78	-	-	-
GH2-0700A	63	63,5	159	140	251	356	529	181	610	210	171	84	-	-	-
GH2-0800C	43	66	128	175	195	310	497	138	610	210	171	78	-	-	-
GH2-0800B	45	66	128	155	195	310	497	138	610	210	171	84	-	-	-
GH2-0800A	75	70	164	175	326	463	551	237	610	210	171	84	-	-	-
GH2-0900C	45	66	128	155	195	310	497	138	610	210	171	84	-	-	-
GH2-0900B	63	63,5	159	140	251	356	529	181	610	210	171	84	-	-	-
GH2-0900A	75	70	164	175	326	463	551	237	610	210	171	84	-	-	-
GH2-1000A	75	70	164	175	326	463	551	237	610	210	171	84	-	-	-
GH2-1200B	75	70	164	175	326	463	551	237	610	210	171	84	-	-	-
GH2-1200A	188	83	175	178	400	565	655	292	610	-	-	-	284	94	188



CENTERLINE-Butterfly Valves Series RS

Spare parts DN 40-1200 Replaceable Seat Ring

Body liner	
Material	Identity code
EPDM	9E-000B ^{*1)}
EPDM-H	8L
NBR	8N
HNBR	8H
FPM	8F
CSM	8C

Size		Article number
40	1,5"	KS1A0040-XX-0000
50	2"	KS1A0050-XX-0000
65	2,5"	KS1A0065-XX-0000
80	3"	KS1A0080-XX-0000
100	4"	KS1A0100-XX-0000
125	5"	KS1A0125-XX-0000
150	6"	KS1A0150-XX-0000
200	8"	KS1A0200-XX-0000
250	10"	KS1A0250-XX-0000
300	12"	KS1A0300-XX-0000
350	14"	KS1A0350-XX-0000
400	16"	KS1A0400-XX-0000
450	18"	KS1A0450-XX-0000
500	20"	KS1A0500-XX-0000
600	24"	KS1A0600-XX-0000
700	28"	KS1A0700-XX-0000
800	32"	KS1A0800-XX-0000
900	36"	KS1A0900-XX-0000
1000	40"	KS1A1000-XX-0000
1200	48"	KS1A1200-XX-0000

"XX" in the article number is to be replaced by the identity code listed for the material. Example:
Body liner DN 200 made of NBR: KS1A0200-8N-0000

^{*1)} only DN 40–250, for DN 300–1200 8L is to be specified
Inner part DN 40 equal DN 50



RS/DB-0009-GB/07.04/GP

CRANE[®]

Spare parts DN 40 -1200 Shaft / Lower Stem

Material	Identity Code
Chromium Steel, 1.4021	6A
Stainless Steel, 1.4401	6B

Size		GG25 Shaft for Body EN-GJL-250	Article number GGG40 Shaft for Body EN-GJS-400-15 GP 240 GH	Lower stem
40	1,5"	KW1B0050XX000	KW1B0050XX000	KW2A0050XX000
50	2"	KW1B0050XX000	KW1B0050XX000	KW2A0050XX000
65	2,5"	KW1B0065XX000	KW1B0065XX000	KW2A0065XX000
80	3"	KW5B0080XX000	KW1B0065XX000	KW2A0065XX000
100	4"	KW5B0100XX000	KW1B0100XX000	KW2A0100XX000
125	5"	KW5B0125XX000	KW1B0125XX000	KW2A0125XX000
150	6"	KW5B0125XX000	KW1B0125XX000	KW2A0125XX000
200	8"	KW5A0200XX000	KW1A0200XX000	KW2A0200XX000
250	10"	KW1A0250XX000	KW1A0250XX000	KW2A0250XX000
300	12"	KW1A0300XX000	KW1A0300XX000	KW2A0300XX000
350	14"		KW1A0350XX000	KW2A0350XX000
400	16"		KW1A0350XX000	KW2A0350XX000
450	18"		KW1A0450XX000	KW2A0450XX000
500	20"		KW1A0450XX000	KW2A0450XX000
600	24"		KW1A0600XX000	KW2A0600XX000
700	28"		KW1A0700XX000	KW2A0700XX000
800	32"		KW1A0800XX000	KW2A0800XX000
900	36"		KW1A0900XX000	KW2A0900XX000
1000	40"		KW1A1000XX000	KW2A1000XX000
1200	48"		KW1A1200XX000	KW2A1200XX000

„XX“ in the article number is to be replaced by the identity code listed for the material.
Example: Shaft Size DN 200 made of Chromium steel : KW1A02006A0000



CENTERLINE-Butterfly Valves Series VIA/RS

Spare Parts DN 40-1200

Discs

DN	Shutoff Pressure bar	GGG ni. pltd.	Stainless Steel	Alu-Bronze	Hastelloy-C	Material Hastelloy-C22C	Duplex	ECTFE coated	VIADUR coated	Hostalen GUR lined
50	16		KD1B0050 3HW000	KD1B0050 4CP000						
	10		KD1B0050 3HW000	KD1B0050 4CN000	KD1B0050 4AN000		KD1B0050 4DN000	KD1B0050 1BS03E		KD1B0050 1BNB3B
65	16		KD1B0065 3HW000	KD1B0065 4CP000						
	10		KD1B0065 3HW000	KD1B0065 4CN000	KD1B0065 4AN000		KD1B0065 4DN000	KD1B0065 1BS03E		KD1B0065 1BNB3B
80	16		KD1B0080 3HW000	KD1B0080 4CP000						
	10		KD1B0080 3HW000	KD1B0080 4CN000	KD1B0080 4AN000		KD1B0080 4DN000	KD1B0080 1BS03E		KD1B0080 1BNB3B
100	16		KD1B0100 3HP000	KD1B0100 4CP000						
	10		KD1B0100 3HN000	KD1B0100 4CN000	KD1B0100 4AN000		KD1B0100 4DN000	KD1B0100 1BS03E		KD1B0100 1BNB3B
	3,5		KD1B0100 3HM000							
125	16		KD1B0125 3HP000	KD1B0125 4CP000						
	10		KD1B0125 3HN000	KD1B0125 4CN000	KD1B0125 4AN000		KD1B0125 4DN000	KD1B0125 1BS03E		KD1B0125 1BNB3B
	3,5		KD1B0125 3HM000							
150	16		KD1B0150 3HP000	KD1B0150 4CP000						
	10		KD1B0150 3HN000	KD1B0150 4CN000	KD1B0150 4AN000		KD1B0150 4DN000	KD1B0150 1BS03E		KD1B0150 1BNB3B
	3,5		KD1B0150 3HM000							
200	16	KD1A0200 1BP03N	KD1A0200 3AP000	KD1A0200 4CP000						
	10	KD1A0200 1BN03N	KD1A0200 3AN000	KD1A0200 4CN000	KD1A0200 4AN000		KD1A0200 4DN000	KD1A0200 1BS03E	KD1A0200 1BS03M	KD1A0200 1BNB3B
	3,5	KD1A0200 1BM03N	KD1A0200 3AM000							
250	16	KD1A0250 1BP03N	KD1A0250 3AP000	KD1A0250 4CP000						
	10	KD1A0250 1BN03N	KD1A0250 3AN000	KD1A0250 4CN000	KD1A0250 4AN000		KD1A0250 4DN000	KD1A0250 1BS03E	KD1A0250 1BS03M	KD1A0250 1BNB3B
	3,5	KD1A0250 1BM03N	KD1A0250 3AM000							
300	16	KD1A0300 1BP03N	KD1A0300 3AP000	KD1A0300 4CP000						
	10	KD1A0300 1BN03N	KD1A0300 3AN000	KD1A0300 4CN000	KD1A0300 4AN000		KD1A0300 4DN000	KD1A0300 1BS03E	KD1A0300 1BS03M	KD1A0300 1BNB3B
	3,5	KD1A0300 1BM03N	KD1A0300 3AM000							

DN 40 discs as DN 50

Other sizes see back page

RS/DB-0010-GB/02.03/GP

DN	Shutoff Pressure bar	GGG ni. pltd.	Stainless Steel	Alu-Bronze	Hastelloy-C	Material Hastelloy-C22C	Duplex	ECTFE coated	VIADUR coated	Hostalen GUR lined
350	16	KD1A0350 1BP03N	KD1A0350 3AP000	KD1A0350 4CP000						
	10	KD1A0350 1BN03N	KD1A0350 3AN000	KD1A0350 4CN000	KD1A0350 4AN000		KD1A0350 4DN000	KD1A0350 1BS03E	KD1A0350 1BS03M	KD1A02350 1BNB3B
	3,5	KD1A0350 1BM03N	KD1A0350 3AM000							
400	16	KD1A0400 1BP03N	KD1A0400 3AP000	KD1A0400 4CP000						
	10	KD1A0400 1BN03N	KD1A0400 3AN000	KD1A0400 4CN000	KD1A0400 4AN000		KD1A0400 4DN000	KD1A0400 1BS03E	KD1A0400 1BS03M	KD1A0400 1BNB3B
	3,5	KD1A0400 1BM03N	KD1A0400 3AM000							
450	16	KD1A0450 1BP03N	KD1A0450 3AP000	KD1A0450 4CP000						
	10	KD1A0450 1BN03N	KD1A0450 3AN000	KD1A0450 4CN000	KD1A0450 4AN000		KD1A0450 4DN000	KD1A0450 1BS03E	KD1A0450 1BS03M	KD1A0450 1BNB3B
	3,5	KD1A0450 1BM03N	KD1A0450 3AM000							
500	16	KD1A0500 1BP03N	KD1A0500 3AP000	KD1A0500 4CP000						
	10	KD1A0500 1BN03N	KD1A0500 3AN000	KD1A0500 4CN000	KD1A0500 4AN000		KD1A0500 4DN000	KD1A0500 1BS03E	KD1A0500 1BS03M	KD1A0500 1BNB3B
	3,5	KD1A0500 1BM03N	KD1A0500 3AM000							
600	16	KD1A0600 1BP03N	KD1A0600 3AP000	KD1A0600 4CP000						
	10	KD1A0600 1BN03N	KD1A0600 3AN000	KD1A0600 4CN000	KD1A0600 4AN000		KD1A0600 4DN000	KD1A0600 1BS03E	KD1A0600 1BS03M	KD1A0600 1BNB3B
	3,5	KD1A0600 1BM03N	KD1A0600 3AM000							
700	10	KD1A0700 1BN03N	KD1A0700 3AN000			KD1A0700 4HN000	KD1A0700 4DN000	KD1A0700 1BS03E	KD1A0700 1BS03M	KD1A0700 1BNB3B
800	10	KD1A0800 1BN03N	KD1A0800 3AN000			KD1A0800 4HN000	KD1A0800 4DN000	KD1A0800 1BS03E	KD1A0800 1BS03M	KD1A0800 1BNB3B
900	10	KD1A0900 1BN03N	KD1A0900 3AN000			KD1A0900 4HN000	KD1A0900 4DN000	KD1A0900 1BS03E	KD1A0900 1BS03M	KD1A0900 1BNB3B
1000	10	KD1A1000 1BN03N	KD1A1000 3AN000			KD1A1000 4HN000	KD1A1000 4DN000	KD1A1000 1BS03E	KD1A1000 1BS03M	
1200	10	KD1A1200 1BN03N	KD1A1200 3AN000			KD1A1200 4HN000	KD1A1200 4DN000	KD1A1200 1BS03E	KD1A1200 1BS03M	



CENTERLINE-Butterfly Valves Series VIA/RS

Chemical Resistance of the Seat

The following Seat Material/Fluid combinations are based on practical experience. The materials quoted may not be suitable for all line media over the entire temperature range. Chemical resistance of the seat can be affected by fluid concentration, temperature,

pressure, flow rate and ventilation. Therefore the suitability of any seat material/fluid combination cannot be guaranteed. If in doubt, the suitability should be checked by testing under the required operating conditions.

RS/DB-0011-GB/02.03/GP

Valve seat material	Resistant against	Temperature range
NBR (Perbunan)* Acrylonitrile Butadiene Rubber	Petroleum, grease, alcohol, glycol, propane, butane, diesel fuels, compressed air, latex and many other media.	-20 °C to +80 °C or up to +110°C for intermittent operation
HNBR (Therban)* Hydrogenated Acrylonitrile Butadiene Rubber	Petroleum, grease, alcohol, glycol, propane, butane, diesel fuels, alkalis, salts, amines, ammonia, many other media. Highly polluted media with high velocity, abrasive media.	-20 °C up to +120 °C
EPDM Ethylene Propylene Terpolymer	Ozone, phosphate, ester, ketones, alcohols, glycols, dilute-sulphuric acid, alkaline solutions in general, treated water (with caustic soda, sodium sulphite, chlorine), hot water and steam (it is attacked by hydrocarbonaceous solutions and oils, chlorinated hydrocarbons, turpentine and all other petroleum based oils).	-34 °C up to +120 °C
EPDM-H	As EPDM including drinking water approval (KTW/DVGW).	-34 °C up to +140 °C
CSM (Hypalon)* Chlorosulphonated Polyethylene Fluorelastomer	Sodium chloride, chromic acid, nitric and hydrofluoric acid, sulphuric acid, hydrocarbon oils, salts, chlorine bleaches and others.	-20 °C up to +80 °C or up to +100°C for intermittent operation
FPM (Viton)* Fluorelastomer	Strong and weak mineral acids, aliphatic hydrocarbons, aromatic phenolic and halogenated hydrocarbons, ester of aromatic acids, aliphatic acids, phosphoric acids, phosphoric ester, aromatic ethers, aliphatic ethers, ozone, chlorine and hypochlorite. (Viton* is not suitable for dry heat, hot water and steam).	-20 °C up to +150 °C

* Trademark or Tradename

CRANE[®]