



## 31000 Series Rotary Control Valves

Eccentric Rotary Control Valves with PFA Liner



# Dresser Masoneilan 31000 Series Rotary Control Valves

## Eccentric Rotary Control Valves with PFA Liner



## Table of Contents

Features .....	3
Numbering System .....	4
General Data.....	5
Connections.....	6
Pressure / Temperature Rating.....	6
Seat Leakage .....	6
C <sub>v</sub> and F <sub>L</sub> .....	7
Materials of Construction .....	8
Dimensions and Weights .....	10

## Features

The 31000 Series control valve is a PFA lined, eccentric plug control valve for corrosive applications which incorporates the following features:

### Excellent Performance

The eccentric rotary plug design provides excellent throttling control accuracy, low dynamic forces and tight shut off. The straight through flow pattern results in high flow capacities.

### Corrosion Resistance

PFA lining with guaranteed minimum wall thickness provides resistance to most corrosive fluids.

### Reduced Fugitive Emissions

The rotary design inherently reduces wear on the packing as compared to a typical linear valve. Additionally, the standard design includes PTFE/Graphite packing, chevron rings, backed-up by a double O-ring follower to provide further reliability in corrosive applications.

### Ease of Maintenance

The compact dimensions and low weight design allows for easy installation and removal without compromising piping forces.

### Reliability

The dovetail grooves provide mechanical anchoring between metal body and PFA lining to ensure high performance under vacuum and at high temperature. The powerful, field proven rolling diaphragm actuator provides positive fail-safe action. The actuator linkage is totally enclosed that comes with a combination handwheel and adjustable limit stop with locking mechanism. All actuators are available with a complete line of options and accessories.

Trade names noted are for reference only. Masoneilan reserves the right to supply trade named material or its equivalent.

# Numbering System

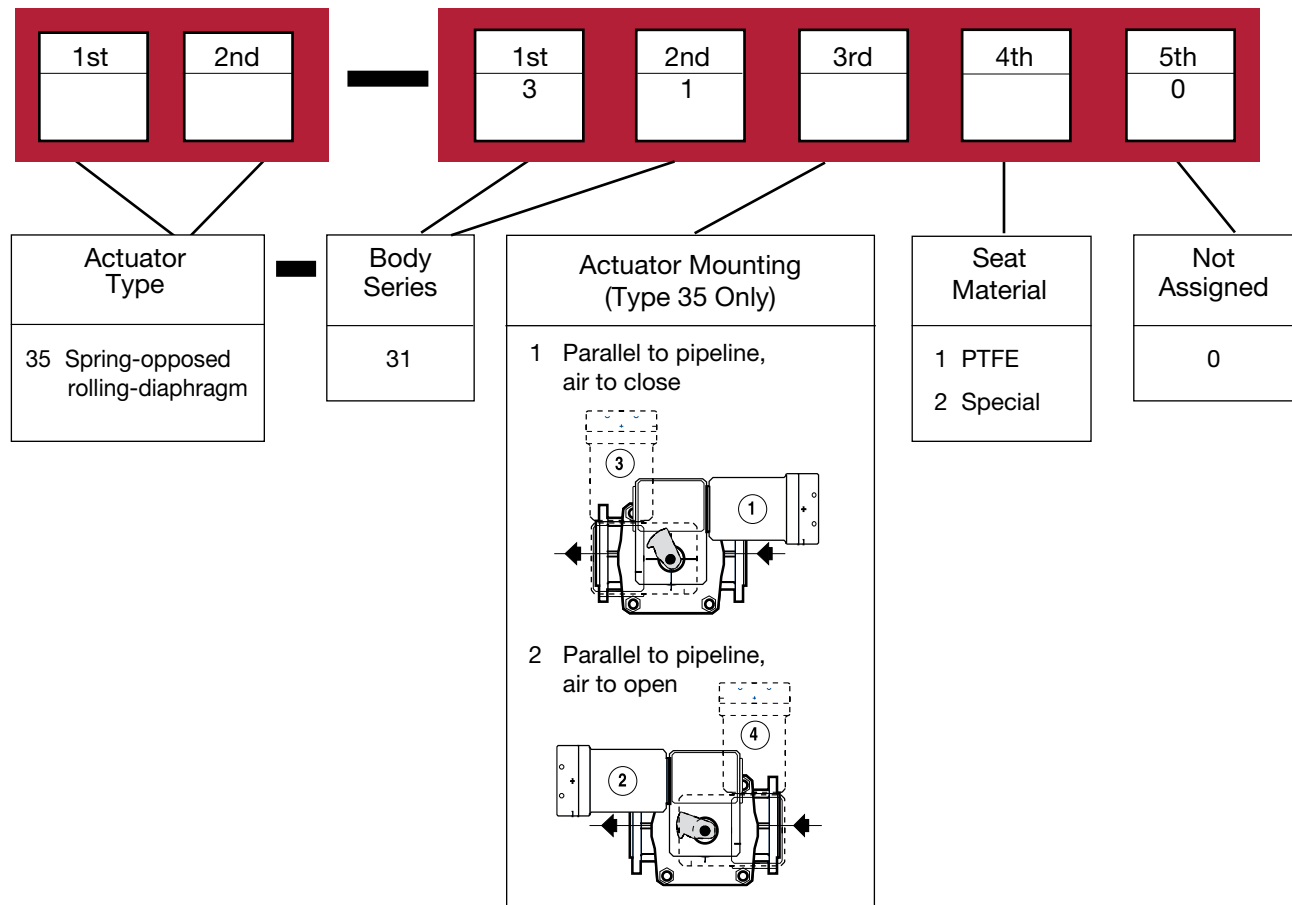

Note: Actuator positions ① and ② are standard configurations. View seen from actuator end. **Other positions are available: consult Masoneilan.**

# General Data

## ■ Body and Bonnet

Type:	Cast, one piece, top entry, self flushing Optional: with steam/hotwater jacket (SJ)
Material:	Nodular ductile iron, heat treated
Lining:	PFA, translucent, melt processed Optional: antistatic material
Connections:	Flanged
Bonnet connection:	Through-bolted
Outside protection:	Epoxy coating

## ■ Trim

Plug type:	Eccentrically rotating
Plug materials:	PFA coated stainless steel
Seat ring type:	Conical, sealed with O-ring
Seat ring material:	Virgin PTFE Optional: other materials (consult Masoneilan) Optional: PFE O-ring

Capacity:	Full capacity and reduced factor in all sizes
Flow characteristic:	Modified linear
C <sub>v</sub> ratio:	80:1
Packing:	PTFE/Graphite, chevron type rings backed up by a double O-ring follower Optional: leak detector or flushing connection

## ■ Flow Direction:

Flow to close

## ■ Actuator:\*

Type:	Spring-opposed rolling-diaphragm (Model 35)
Yoke:	Cast iron Optional: auxiliary handwheel / limit-stop manual actuator (Model 20)

\* Refer to specific actuator and accessory specification literature for complete information.

# Connections

Valve Size		PN Connections		ANSI Connections	
Inches	mm	Flanges	Face to Face Dimensions	Flanges	Face to Face Dimensions
1, 2, 3	25, 50, 80	PN 10 <sup>(1)</sup> PN 16 (125 AARH)	IEC 534-3 <sup>(2)</sup> Table II	150 RF <sup>(3)</sup> (125 AARH)	ANSI B16.10 Globe Control Valve

1) Connections according to all standard PN (ISO, EN and equivalent national standards, AFNOR, BS, DIN, etc.)

2) Equivalent to DIN 3202/F1

3) Connections according to ANSI B16.5

## Pressure / Temperature Rating

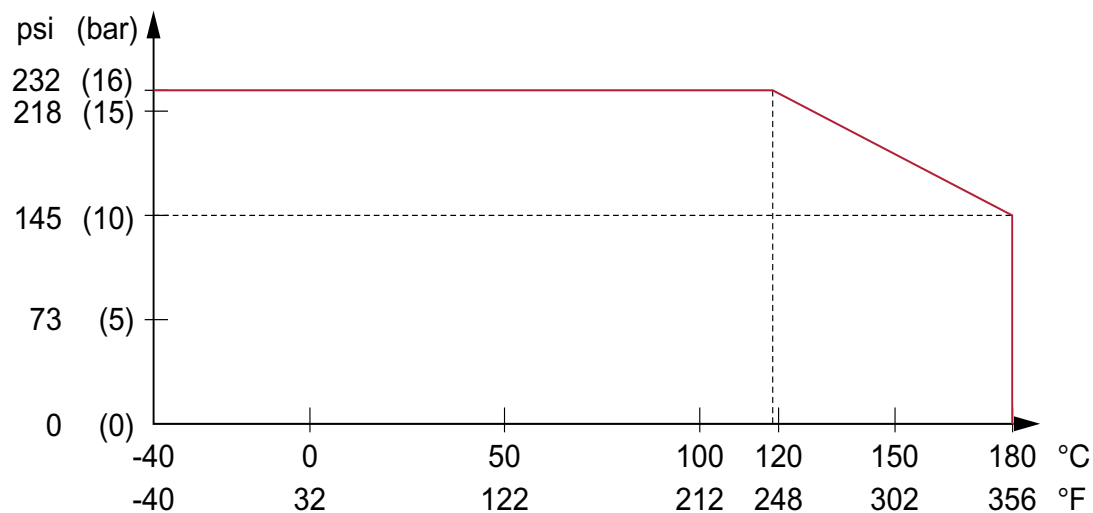

Vacuum operation within the same temperature range.

## Seat Leakage

Leakage Class VI, according to IEC 534-4 and ANSI/FCI 70.2



# C<sub>v</sub> and F<sub>L</sub>

Valve Size		Orifice Diameter	Actuator Travel	F <sub>L</sub>	C <sub>v</sub>
Inches	mm	in. (mm)	in. (mm)		
1	25	–	3.5 (89)	0.64	1.2
		–	3.5 (89)	0.64	2
		–	3.5 (89)	0.64	3
		–	3.5 (89)	0.64	4
		.394 (10)	3.5 (89)	0.64	5
		.472 (12)	3.5 (89)	0.64	8
		.669 (17)	3.5 (89)	0.64	14
		.827 (21)	3.5 (89)	0.64	20
2	50	–	3.5 (89)	0.64	10
		.945 (24)	3.5 (89)	0.64	33
		1.299 (33)	3.5 (89)	0.64	59
		1.575 (40)	3.5 (89)	0.64	82
3	80	1.732 (44)	3.5 (89)	0.64	104
		2.283 (58)	3.5 (89)	0.64	182
		3.071 (71)	3.5 (89)	0.64	260

# Materials of Construction

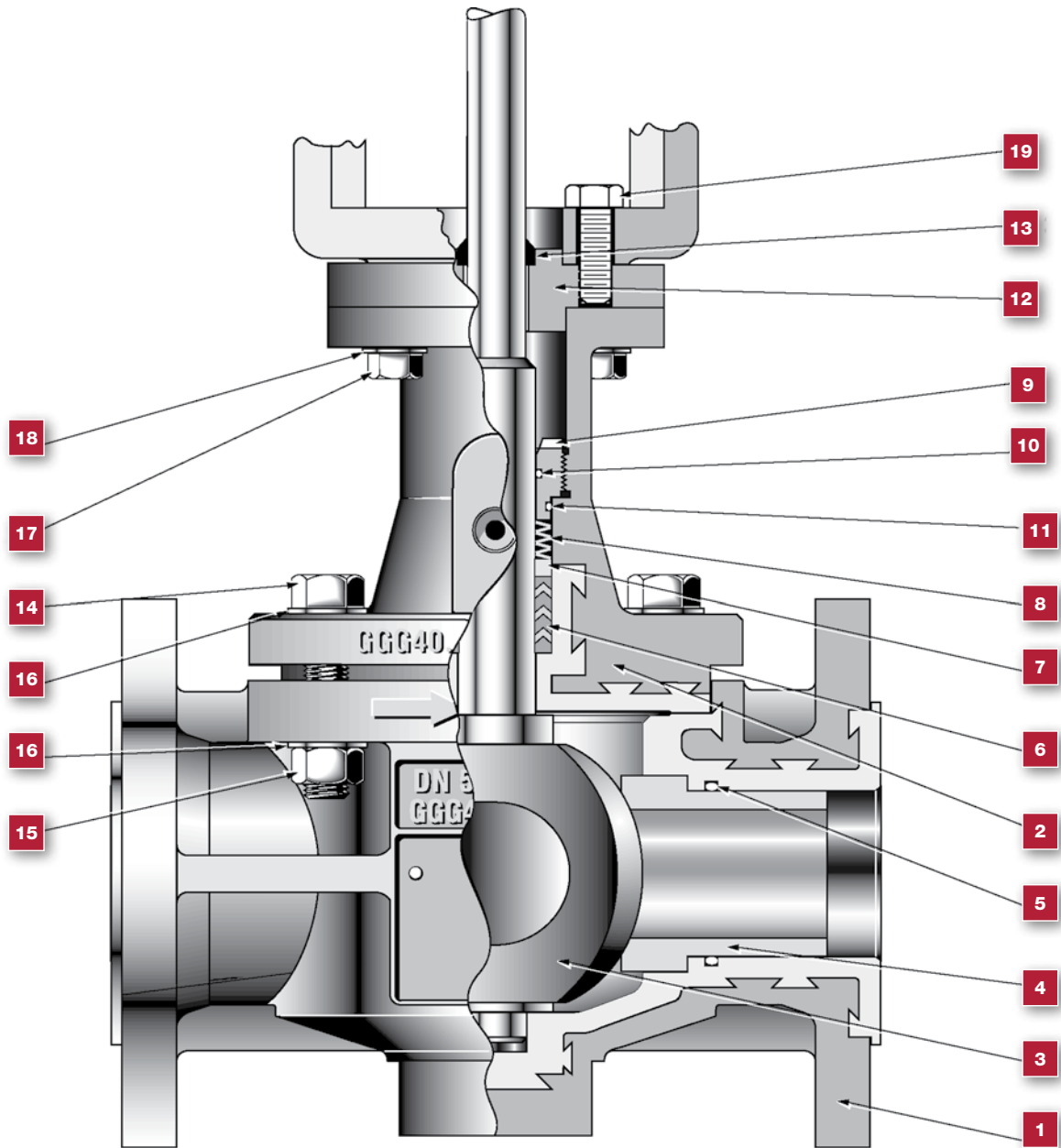

Note: leak detector or flushing connection is optional



# Materials of Construction

Ref. No.	Description	Standard Materials (Optional Materials)
1	Body	Ductile Iron ASTM A395/PFA Lined
2	Bonnet	Ductile Iron ASTM A395/PFA Lined
3	Plug	PFA encapsulated Stainless Steel
4	Seat Ring	Virgin Solid PTFE <i>Other Materials (Consult Masoneilan)</i>
5	O-Ring	FEP coated Viton® <i>Perfluoroelastomer (PFE)</i>
6	Packing	PTFE/Graphite - Chevron Ring System
7	Packing Box Ring	Stainless Steel
8	Disc Springs (Set)	Spring Steel
9	Packing Follower	Stainless Steel
10-11	O-Rings	Viton®
12	Actuator Connecting Flange	Stainless Steel
13	Wiper Ring	Neoprene
14-19	Bolting	Stainless Steel

# Dimensions and Weights

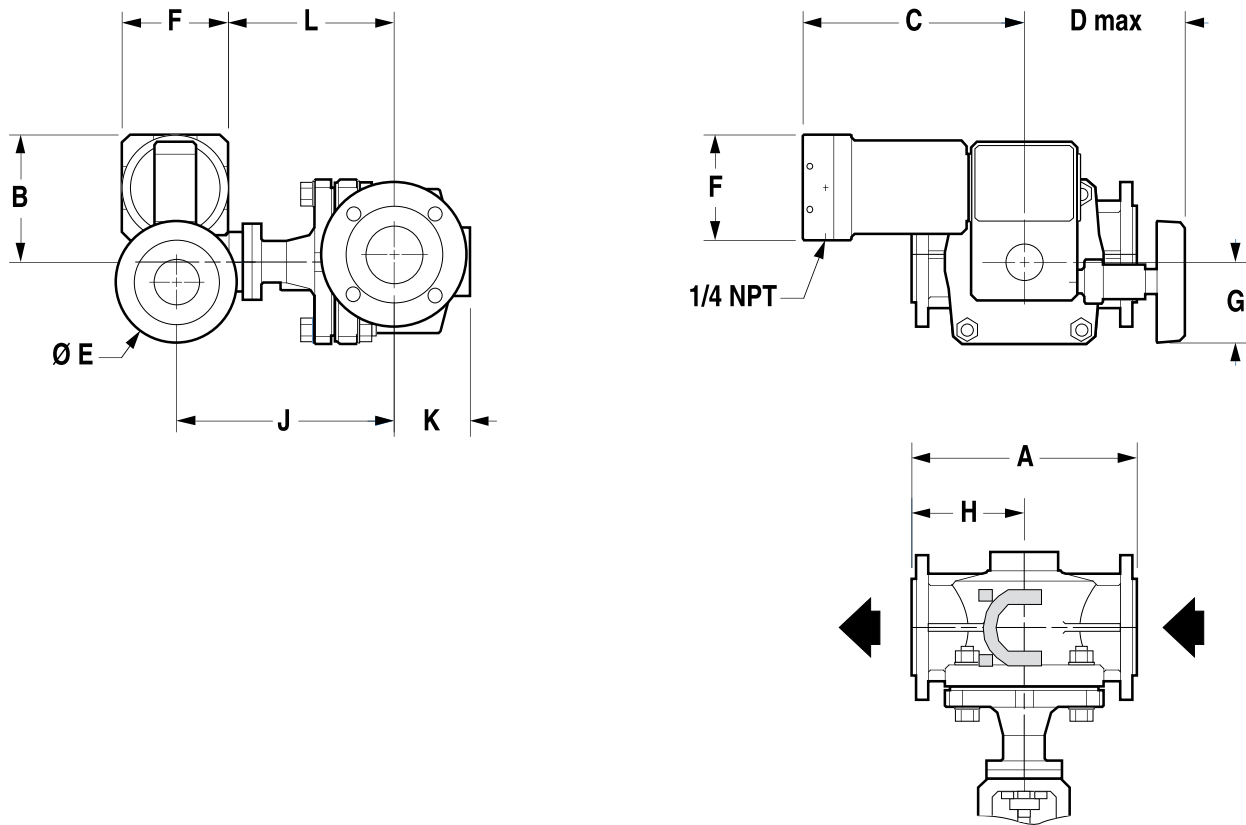

Dimensions (inches)

Valve Size		A		B	C	D	E	F	G	H		J	K	L	Weight* (lbs)
Inch	DN	PN 10 PN 16	ANSI Class 150							PN 10 PN 16	ANSI Class 150				
1	25	6.30	7.25	6.93	11.81	8.31	6.42	5.52	4.61	3.15	3.62	10.04	2.05	7.28	40
2	50	9.06	10.00	6.93	11.81	8.31	6.42	5.52	4.61	4.53	5.00	10.63	3.07	7.87	60
3	80	12.21	11.75	6.93	11.81	8.31	6.42	5.52	4.61	6.10	5.87	11.42	3.94	8.66	97

\* Including Handwheel

# Dimensions and Weights

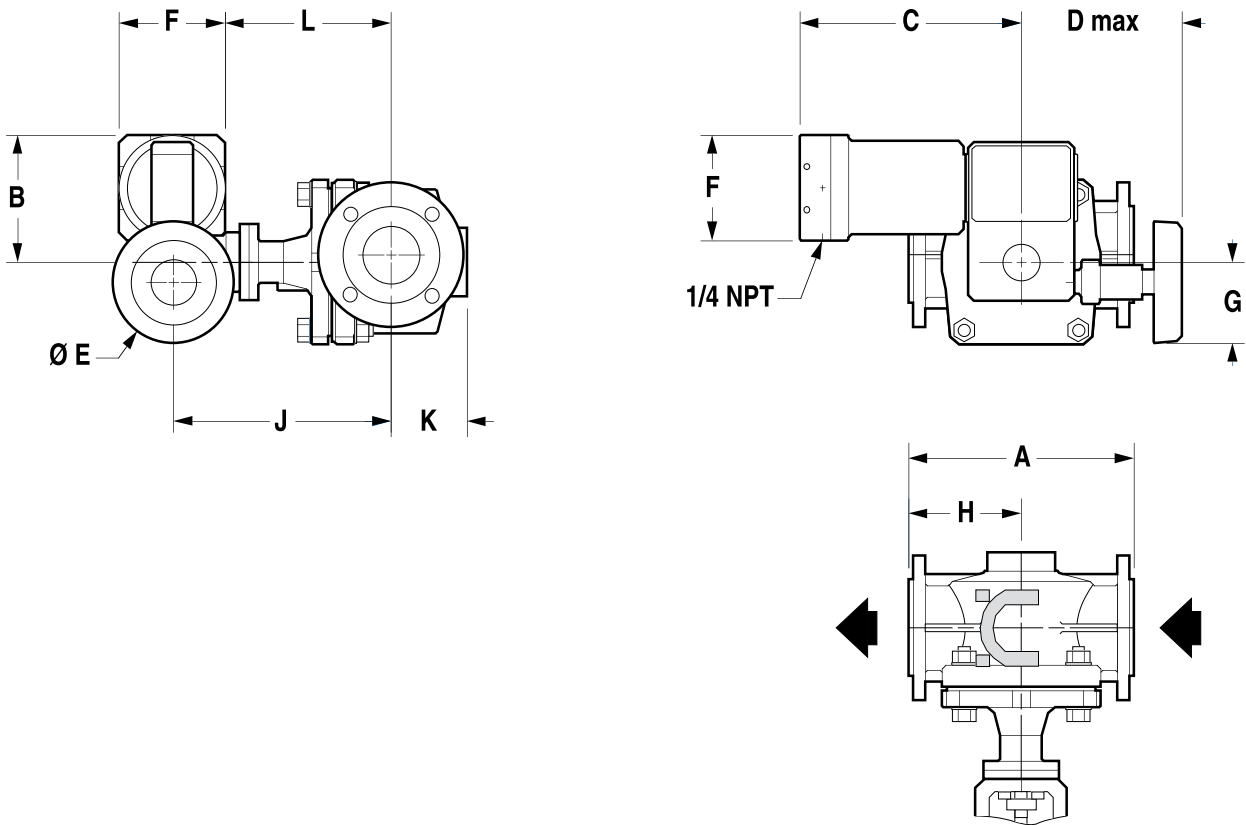

Dimensions (millimeters)

Valve Size		A		B	C	D	E	F	G	H		J	K	L	Weight* (kg)
Inch	DN	PN 10 PN 16	ANSI Class 150							PN 10 PN 16	ANSI Class 150				
1	25	160	184	176	300	211	163	140	117	80	92	255	52	185	18
2	50	230	254	176	300	211	163	140	117	115	127	270	78	200	27
3	80	310	298	176	300	211	163	140	117	155	149	290	100	220	44

\* Including Handwheel

# DIRECT SALES OFFICE LOCATIONS

## BELGIUM

Phone: +32-2-344-0970  
Fax: +32-2-344-1123

## BRAZIL

Phone: +55-11-2146-3600  
Fax: +55-11-2146-3610

## CANADA

Ontario  
Phone: +905-335-3529  
Fax: +905-336-7628

## CHINA

Phone: +86-10-8486-4515  
Fax: +86-10-8486-5305

## FRANCE

Courbevoie  
Phone: +33-1-4904-9000  
Fax: +33-1-4904-9010

## GERMANY

Viersen  
Phone: +49-2162-8170-0  
Fax: +49-2162-8170-280

## INDIA

Mumbai  
Phone: +91-22-8354790  
Fax: +91-22-8354791  
New Delhi  
Phone: +91-11-2-6164175  
Fax: +91-11-5-1659635

## ITALY

Phone: +39-081-7892-111  
Fax: +39-081-7892-208

## JAPAN

Chiba  
Phone: +81-43-297-9222  
Fax: +81-43-299-1115

## KOREA

Phone: +82-2-2274-0748  
Fax: +82-2-2274-0794

## MALAYSIA

Phone: +60-3-2161-0322  
Fax: +60-3-2163-6312

## MEXICO

Phone: +52-5-310-9863  
Fax: +52-5-310-5584

## THE NETHERLANDS

Phone: +0031-15-3808666  
Fax: +0031-18-1641438

## RUSSIA

Veliky Novgorod  
Phone: +7-8162-55-7898  
Fax: +7-8162-55-7921  
Moscow  
Phone: +7 495-585-1276  
Fax: +7 495-585-1279

## SAUDI ARABIA

Phone: +966-3-341-0278  
Fax: +966-3-341-7624

## SINGAPORE

Phone: +65-6861-6100  
Fax: +65-6861-7172

## SOUTH AFRICA

Phone: +27-11-452-1550  
Fax: +27-11-452-6542

## SOUTH & CENTRAL AMERICA AND THE CARIBBEAN

Phone: +55-12-2134-1201  
Fax: +55-12-2134-1238

## SPAIN

Phone: +34-93-652-6430  
Fax: +34-93-652-6444

## UNITED ARAB EMIRATES

Phone: +971-4-8139-200  
Fax: +971-4-8838-038

## UNITED KINGDOM

Woburn Green  
Phone: +44-1628-536300  
Fax: +44-1628-536319

## UNITED STATES

Massachusetts  
Phone: +1-508-586-4600  
Fax: +1-508-427-8971

## Corpus Christi, Texas

Phone: +1-361-881-8182  
Fax: +1-361-881-8246

## Dresser Direct

## Deer Park, Texas

Phone: +1-281-884-1000  
Fax: +1-281-884-1010

## Dresser Flow Technologies

## Houston, Texas

Phone: +1-281-671-1640  
Fax: +1-281-671-1735

## California

Phone: +1-562-941-7610  
Fax: +1-562-941-7810

## About Dresser, Inc.

Dresser Inc. is a global leader in providing highly-engineered infrastructure products for the global energy industry.

Leading brand names within the Dresser portfolio include Dresser Wayne® retail fueling systems, Waukesha® natural gas-fired engines, Masoneilan® control valves, Consolidated® pressure relief valves, and ROOTS® blowers and rotary gas meters. The company has manufacturing and customer service facilities strategically located worldwide and a sales presence in more than 150 countries. [www.dresser.com](http://www.dresser.com)

## About Dresser Masoneilan

Dresser Masoneilan, headquartered in Houston, Texas, has been the leading global partner in process control valves and solutions for more than 100 years. A business segment of Dresser, Inc., the company delivers customized products, services and diagnostic solutions for oil and gas, process and power generation applications. [www.dresser.com](http://www.dresser.com)

## Dresser Masoneilan

### Dresser, Inc., Flow Technologies

10343 Sam Houston Park Drive  
Houston, Texas 77064 U.S.A  
T. +1-281-671-1640  
F. +1-281-671-1735  
E. [sales@masoneilan.com](mailto:sales@masoneilan.com)

